

Au Courant



 LEDA



Dining Table Detail: Refractory top finished in a distressed Pin-knotty Cherry veneer.

Directoire Style (Pronunciation: dErektwar), in French interiors and clothing, during the period of rule by the Directory (1795-1799), from which the name is derived. A style transitional between Louis XVI and Empire, it is characterized by a departure from the sumptuousness of the aristocratic regime. Furniture became more angular and severe: most marquetry was replaced by large surfaces of painted and waxed wood. These new forms and the continued taste for Greco-Roman design, forecasted the Empire Style.

After the revolution, the nine years of the Directoire found France ruled by five directors who held executive power in France. All signs of aristocracy and royalty were eliminated and furniture design was controlled by a Jury of Arts and Manufacturers. The delicacy of the forms of the Louis XVI period was continued, but new ornamental motifs were introduced. Woodcarvers

and painters drew inspiration from military objects such as spears, drums, trumpets, stars and caps of the revolutionary armies. Roman and Egyptian influences continue to be noticeable, in addition to reflecting the growing power of the agricultural classes: the plough, flail, scythe, and sheaves of wheat.

A pause between the revolution and the Consulate, France discovers a gentleness of spirit. The elegant simplicity of the cherrywood from the Directoire collection makes them perfect and discreet companion pieces.

The authenticity of this unique collection is preserved through use of visible doweling, decorative lozenges, ebony marquetry border (symbol of the cabinet-makers' mourning for their King) and brass shoes for the feet of furniture.



#20-100 4-Door Buffet

- Buffet features top drawer cutlery tray
- Adjustable wooden shelf behind doors
- Built-in adjustable levelers

Dimensions:	L	W	H
	75	22	35 in.
	191	56	89 cm

#20-110 4- Door Hutch

- Glass beveled doors & side panels
- Mirrored back
- 10mm adjustable sectional shelves
- Hutch crown with detailed marquetry
- Multi-setting touch hinge halogen lighting

Dimensions:	L	W	H
	80	23	53 in.
	203	58	135 cm

#20-120 Trestle Table

- Refractory top
- 2 x 14" (36cm) extension leaves
- Opens to 102" (259cm)
- Decorative solid metal scrolled base

Dimensions:	L	W	H
	74	44	30 in.
	188	112	76 cm

#20-141 Crossback Arm Chair

- Seat size 20"W x 16"D

Dimensions:	L	W	H
	25	27	39 in.
	64	69	99 cm

#20-131 Crossback Side Chair

- Seat size 20"W x 16"D

Dimensions:	L	W	H
	22	27	39 in.
	56	69	99 cm



Trestle Detail

"Au Courant" by
LEDA



#20-101 3- Door Buffet

- Top drawer cutlery tray
- Wooden shelves behind bottom doors
- Built-in adjustable levelers

Dimensions:	L	W	H
	65	20	35 in.
	165	51	89 cm

#20-124 4-Leg Table

- 2 x 18" (46cm.) extension leaves.
- Opens to 104" (270cm)
- Brass tip legs

Dimensions:	L	W	H
	68	44	30 in.
	173	112	76 cm



Marquetry detail

20-111 3-Door Hutch

- Beveled glass doors & side panels
- Mirrored back
- 10mm adjustable sectional shelves
- Multi-level touch hinge halogen lighting
- Hutch crown with inlaid marquetry

Dimensions:	L	W	H
	70	21	53 in.
	178	53	135 cm

2- Piece overall height 88"

Style created for the ages.



#20-121 4-Leg Round Table

- 2-18" (46cm) extension leaves
- Opens to 84" (213cm)
- Brass tip legs

Dimensions:	L	W	H
	48	48	30 in.
	122	122	76 cm

#20- 130 Upholstered Side Chair

- Seat size 20"W x 16"D x 19"H

Dimensions:	L	W	H
	22	27	39 in.
	56	69	99 cm

#20- 140 Upholstered Arm Chair

- Seat size 20"W x 16"D x 19"H

Dimensions:	L	W	H
	25	27	39 in.
	64	69	99 cm

#20-151 Marble Top Sideboard

- Solid taupe marble top

Dimensions:	L	W	H
	52	20	44 in.
	132	51	112 cm

- Top drawer cutlery tray
- Brass tip legs



#20-101 3- Door Buffet

- Top drawer cutlery tray
- Wooden shelves behind bottom doors
- Built-in adjustable levelers

Dimensions:	L	W	H
	65	20	35 in.
	165	51	89 cm

20-111 3-Door Hutch

- Beveled glass doors & side panels
- Mirrored back
- 10mm adjustable sectional shelves
- Multi-setting touch hinge halogen lighting
- Hutch crown with inlaid marquetry

Dimensions:	L	W	H
	70	21	53 in.
	178	53	135 cm

2- Piece overall height 88"

#20-120 Trestle Table

- Refractory top
- 2 x 14" (36cm) extension leaves
- Opens to 102" (259cm)
- Decorative solid metal scrolled base

Dimensions:	L	W	H
	74	44	30 in.
	188	112	76 cm

#20- 130 Upholstered Side Chair

- Seat size 20"W x 16"D x 19"H

Dimensions:	L	W	H
	22	27	39 in.
	56	69	99 cm

#20- 140 Upholstered Arm Chair

- Seat size 20"W x 16"D x 19"H

Dimensions:	L	W	H
	25	27	39 in.
	64	69	99 cm

shown in Brandy finish



"Au Courant" by
LEDA



#20-330 Curio Cabinet

- Side door openings
- Beveled glass front & sides
- 4 x 10mm adjustable glass shelves featuring plate grooves
- Mirrored back
- Multi-level touch-hinge lighting
- Crown with marquetry inlay
- Set on levelers

Dimensions:	L	W	H
	41	21	82 in.
	104	53	208 cm

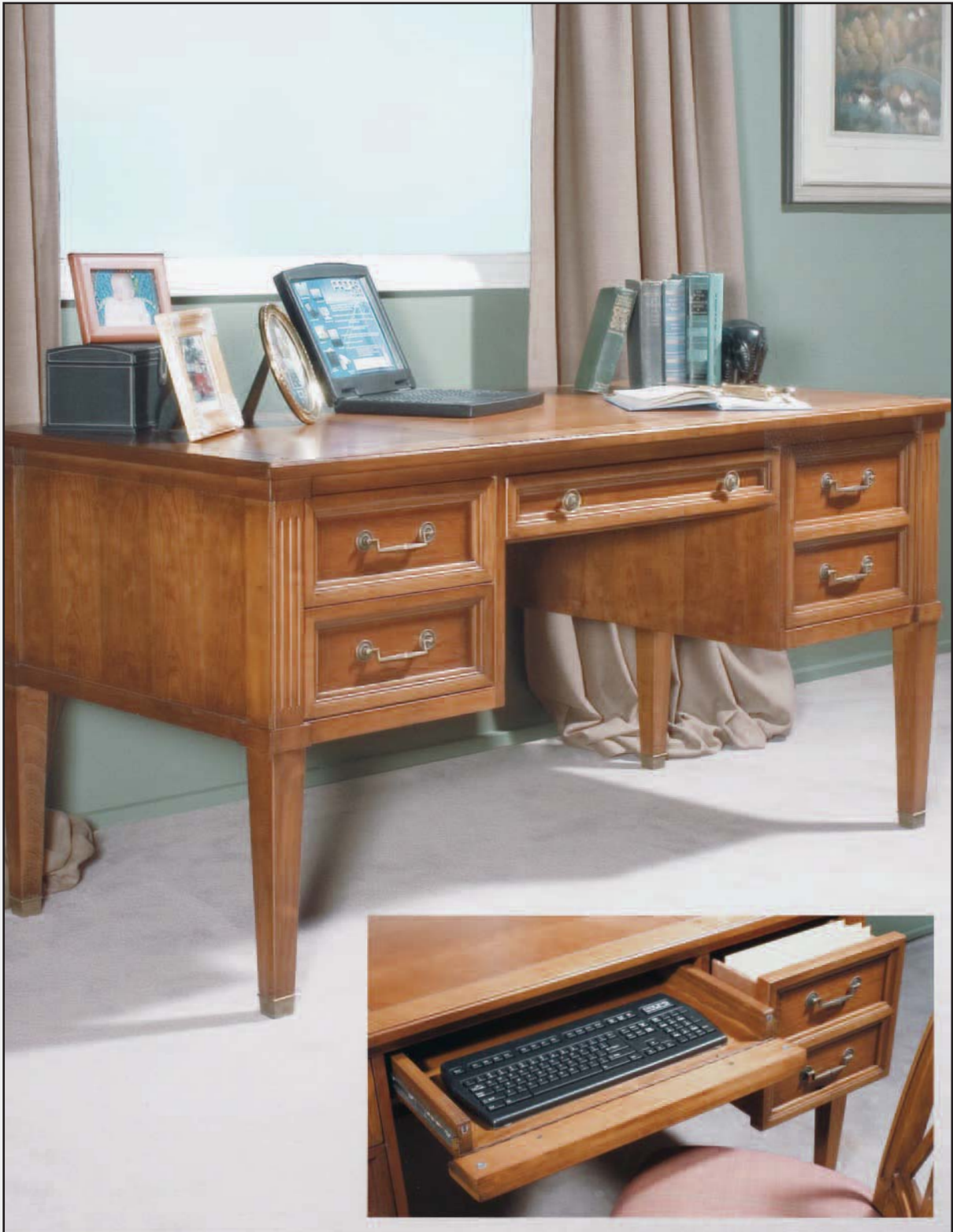

#20-840 Desk

- Drop-front keyboard drawer
- 1 file drawer; letter and legal size files
- 2 box drawers
- Brass feet

Dimensions:	L	W	H
	60	28	30 in.
	152	71	76 cm

"Au Courant" by
LEDA



#20-403 Drum Table
 - Inlaid top
 - Interior Shelf

Dimensions: L W H
 23 23 26 in.
 58 58 66 cm



#20-401 Round End Table
 - Drawer & shelf
 - Brass feet

Dimensions: L W H
 26 26 26 in.
 66 66 66cm



#20-450 Nesting Tables
 - Brass rosettes

Dimensions: L W H
 26 17 24 in.
 66 43 61 cm.



*Design
 Authenticity*



Attention to Detail



#20-411 Oval Coffee Table
- Brass feet

Dimensions:	L	W	H
	48	32	20 in.
	122	81	51 cm



#20-430 Console Table
- Drawer & shelf
- Brass feet

Dimensions:	L	W	H
	48	18	30 in.
	122	46	76 cm

*Distinctive accents
at home
in any environment.*

#20-425 Sofa Table

- 3 Drawers
- Brass feet

Dimensions:	L	W	H
	56	18	30 in.
	142	46	76 cm



"Au Courant" by
LEDA



#20-205 Dresser

Dimensions:	L	W	H
	72	20	38 in.
	188	112	76 cm



#20-225 Door Chest

- Two double-hinge full swing doors
- Two adjustable shelves
- TV opening 39 x 49"H
- Pre-wired cable bar

Dimensions:	L	W	H
	50	24	78 in.
	127	61	198 cm

#20-235 Night Table

Dimensions:	L	W	H
	31	18	32 in.
	188	112	76 cm



Timeless

Versatile

Beauty



#20-320

Entertainment / Wardrobe Armoire

- Two double-hinge full swing doors
- Three interior drawers, three adjustable shelves & clothes rod
- TV opening 48" x 39"
- Pre-wired cable bar
- Marquetry inlays on crown
- Brass feet

Dimensions:	L	W	H
	58	27	82 in.
	104	53	208 cm

"Au Courant" by
LEDA



#20-201 Dresser

- Two interior drawers behind center doors
- Jewelry tray
- Brass feet

Dimensions:	L	W	H
	31	18	29 in.
	79	46	73 cm

#20-211 Mirror

- Beveled edges
- Marquetry inlay across top

Dimensions:	L	W	H
	31	18	29 in.
	79	46	73 cm



#20-241 Queen Platform Bed (shown)

- Slat suspension mattress support system

Dimensions:	L	W	H
	68	89	45 in.
	173	226	114 cm

#20-231 Night Table

- Two drawers

- Brass feet

Dimensions:	L	W	H
	31	18	29 in.
	79	46	73 cm

#20-242 King Platform Bed

- Slat suspension mattress support system

Dimensions:	L	W	H
	68	89	45 in.
	173	226	114 cm

Reminiscent

Transitional

Authenticity

"Au Courant" by
LEDA



#20-311 Computer Armoire

- Two double-hinge full swing doors
- Automatic overhead task light
- Double pull-out working surface
- Master switch power bar with fax and modem plug-in
- Pull-out printer tray
- Letter and legal size file drawer
- 2 adjustable shelves

Dimensions:

L	W	H
57	27	64 in.
145	69	163 cm



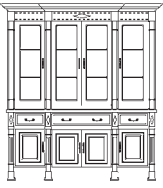

20100 Buffet
20110 Hutch
 80 x 23 x 88"
 203 x 58 x 224cm

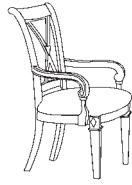

20131 Side Chair
20141 Arm Chair
 25 x 27 x 39"
 64 x 69 x 99cm

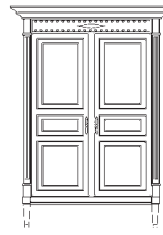

20320 Armoire
 58 x 27 x 82"
 147 x 69 x 208cm



20401 Lamp Table
 26 x 26 x 26"
 66 x 66 x 66cm

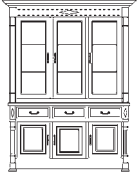

20101 Buffet
20111 Hutch
 70 x 21 x 88"
 178 x 53 x 224cm

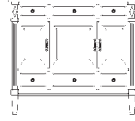

20151 Marble Top Sideboard
 52 x 20 x 44"
 132 x 51 x 112cm



20225 Door Chest
 50 x 24 x 78"
 127 x 61 x 198cm

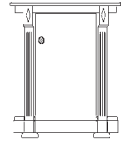

20403 Drum Table
 23 x 23 x 26"
 58 x 58 x 66cm

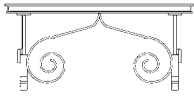

20120 Trestle Table
 74 x 44 x 30"
 188 x 112 x 76cm
 plus 2 - 14" (36) refractory leaves

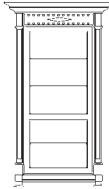

20330 Curio Cabinet
 41 x 21 x 82"
 104 x 53 x 208cm

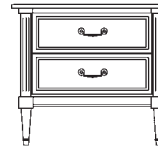

20231 Night Table
 31 x 18 x 29"
 79 x 46 x 74cm



20411 Oval Cocktail Table
 48 x 32 x 20"
 122 x 81 x 51cm



20121 Round Dining Table
 48 x 48 x 30"
 122 x 122 x 76cm
 plus 1 - 18" (46cm) leaf

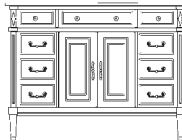

20201 Dresser
 61 x 20 x 44"
 155 x 51 x 112cm



20235 Night Table
 31 x 18 x 32"
 79 x 46 x 81cm

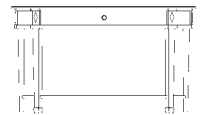

20430 Console
 47 x 19 x 30"
 122 x 46 x 76cm



20124 Leg Table
 68 x 44 x 30"
 173 x 112 x 76cm

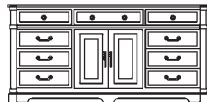

20205 Dresser
 72 x 20 x 38"
 183 x 51 x 97cm

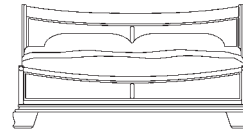

20241 Queen Sleigh Bed
 68 x 89 x 44"
 173 x 226 x 112cm
20242 King Sleigh Bed
 88 x 89 x 44" 224 x 226 x 112cm

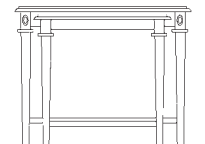

20450 Nest of Tables
 26 x 17 x 24"
 66 x 43 x 61cm

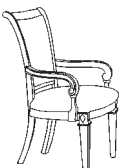

20130 Side Chair
20140 Arm Chair
 25 x 27 x 39"
 64 x 69 x 99cm

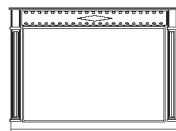

20211 Landscape Mirror
 50 x 36"
 127 x 91cm

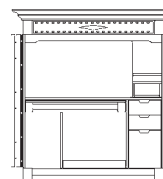

20311 Computer Armoire
 57 x 27 x 64"
 145 x 69 x 163cm

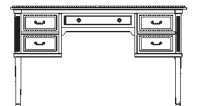

20840 Desk
 60 x 28 x 31"
 152 x 71 x 79cm

THE LEDA STORY

a personal and corporate history

The Leda motto is "Always looking to the future, never losing sight of the past". It was a vision conceived in the heart of Italy, then brought to life in Canada by the company's founders, Lino and Leda Confalone.

Lino's father was a talented artisan in the region of Puglia, a woodworker who hand crafted fine furniture. When he was very young, Lino helped after school in his perfectionist father's shop. "I worked hard and learned the trade from him". He left for Canada when he was an energetic 17, "Just in time for Christmas; it was so cold I wanted to go right back to Italy!"

Coincidentally, Leda was born in Abruzzo, just north of Puglia, her father also a woodworker, and came to Canada with her family when she was seven. Neither Lino nor Leda spoke any English. They met years later in Toronto's "Little Italy" at a grocery store where both families shopped, and married when Leda was 19.

Lino knew he wanted to work with wood, the family tradition, "to use my craft." In Toronto he earned his living in carpentry finishing and the construction of new homes. He progressed to building and installing kitchen cabinets, first from the basement of Leda's family home, then the more spacious garage. But the business grew rapidly and in 1967 Italcraft saw the light of day. Lino moved the enterprise to a 2,700 square foot unit. Leda was a secretary for Toronto Dominion Bank, but moonlighted as Italcraft's bookkeeper and did the company's invoicing at night.

"To us and to our customers the name Italcraft meant that our furniture was made by hand, that we crafted in the old tradition," said Lino.

Marco, their first son, was also born in 1967, a banner year for the couple, and Sergio two years later, in 1969.

In 1972 they moved to an 18,000 square feet factory and office. Lino bought the building in 1973-74. "We were making high quality dining room and bedroom furniture and a variety of accent pieces."

They picked up their tools again in 1981 to occupy a 50,000 square foot facility. "We were still crowded, so we acquired another 15,000 square feet for warehousing."

In 1993, with the addition of wall units, home office and home theatre collections, the burgeoning enterprise moved to its present home at 350 Clayson Road, 150,000 square feet of state-of-the-art manufacturing, warehousing and showroom space, and "now we're crowded again!" But far-sighted Lino has already purchased land for the future where they can accommodate up to 250,000 square feet.

Lino is justifiably proud of the company's top-of-the-line machinery, including a recently acquired new CNC Router with random access for multi-tool selection throughout the machine's assortment of twelve cutting heads. It brings Leda's inventory of sophisticated CNC controlled manufacturing machines to 10, ensuring Leda's status as a truly high-tech furniture manufacturing entity.

Leda observed, "Lino works in five year cycles. He brings the company to a point where he's satisfied, then takes it to the next level of expansion. He loves the challenge of building the business." Lino said, "When we changed our name from Italcraft to Leda, it was to show our pride in our all-Canadian made furniture. The name Leda seemed appropriate; it is elegant, unique like Leda, my wife, and like the furniture we create."

The company has been recognized for superb quality, design and marketing excellence by numerous Ontario Furniture Manufacturers' Association Trillium Awards over the years, including the prestigious Grand Trillium Award. Leda was also honoured with the Better Homes & Gardens Consumer Award in Great Britain.

Leda says that she and Lino "always drive down to the High Point Markets together, spring and fall". The couple is "very proud the boys are deeply involved in the business".

Said Lino, "The past year or so I've come to believe the boys don't really need me anymore, but if they do need me, I'm here. I've told everyone I'll retire, next year, next year, next year, but thus far I haven't! I handed over more responsibility to Marco and Sergio, but I am still here to help them. I could never say 'goodbye' to the business. And I would like to think that maybe our two granddaughters, Sasha and Nicole, would one day be a part of the team."

In January 2003, Marco and Sergio were promoted to the positions of President and Vice President, respectively.

Leda first entered the U.S. market in the early 1990s. The company showed at High Point, "Once only at Hamilton Square, then we moved to IHFC." Five showroom expansions later finds Leda in their current 8500 square foot G576 showroom location.

The company Lino and Leda Confalone founded continues its dramatic development, focused on a strong market-driven, creative philosophy and direction, always making provision for exciting growth and prosperity for every member of the Leda family team. "Always looking to the future, never losing sight of the past!"



Statement of Quality

Leda has manufactured furniture since the late 1960's, utilizing state of the art technology, skills and craftsmanship. Each piece is made to exacting standards and of the highest quality materials available. All pieces are inspected at numerous intervals during the manufacturing process, including a final inspection prior to packaging.

Despite our best efforts some imperfections may occur once the furniture has had time to settle after the manufacturing process. These situations may require repairs and/or part replacements

Leda Furniture selects glass and mirrors of the highest quality to complement the furniture. However the very best glass and mirrors may have certain characteristics that are inherent in the glass making process, these include faint scratches, air bubbles and pitted areas. These minor allowable marks do not detract from the beauty and integrity of the product.

Leda Furniture Ltd stands behind its product in regard to manufacturing related issues (materials, workmanship) for a period of one year from date of shipment from our factory.

Caring for Au Courant:

Wood Finish:

Leda finishes are resistant to most everyday hazards, however some precautions are necessary to maintain the beauty of your furniture.

- regular dusting with a soft clean cloth, slightly moistened with water. Dry completely with a separate dry cloth, always rubbing with the grain pattern.
- avoid contact with harsh solvents, ie. hot dishes, nail polish, alcohol and moisture.
- clean spills immediately.
- use pads when displaying accessories and heated items on table and cabinet
- do not place furniture tops near heating outlets, windows or direct sunlight.

Decorative Hardware:

- clean with a soft damp cloth.
- avoid using harsh detergents or polish on the hardware.

These practices will help your Leda Furniture maintain its beauty and elegance for years to come.

All furniture photographed are available to qualified Leda Furniture retailers. Possession of this catalog does not necessarily constitute authority to purchase, nor does the furnishing of this catalog constitute an offer by Leda to sell any or all of the items contained herein.

All photography, illustrations and specifications in this catalog represent the most current product information available at time of printing. All information, product design and product availability is subject to change without notice.

Quality Durability Longevity

Leda Furniture Ltd. prides itself in manufacturing high quality furniture. All materials used to craft our fine furniture are carefully selected to ensure that each Leda heirloom will last for generations.

Along with quality materials, Leda also incorporates crafting methods and construction features that enhance our furniture design. This attention to detail adds quality and durability to the furniture, as well as convenience and adaptability for the consumer's needs.



Adjustable shelves: Allow for easy and flexible storage space and reorganization.



Accessory Trays: Appropriate cabinets include a convenient and stylish tray to store and protect jewelry, valuables and assorted silverware.



Dovetail joinery: Wedge-shaped projections on the drawer panels interlock with alternating grooves to produce a tight and secure joint.

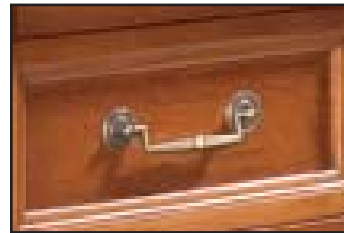

Solid Metal Hardware: Leda Furniture casegoods feature decorative solid metal hardware, aesthetically pleasing to touch and feel, with lasting durability.

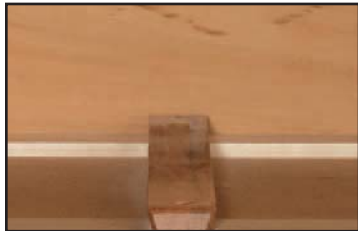

Drawer runners: Strips installed in the drawer opening ensuring an smooth an even slide for the drawer. These strips also add to the cabinet's sturdiness.

Wood Finish:

Leda Furniture maintains strict finishing requirements. Talented craftsmen take extreme pride in the art of finishing, including staining, padding, rubbing and highlighting - all by hand. We are very careful to formulate and apply each finish to exacting standards. However color variations will occur because natural woods vary in their reaction to finishing materials due to age, grain pattern and raw wood tone. The finish shown is reproduced as accurately as printing techniques permit.



Drawer Guides: wooden glides: Installed underneath each drawer designed to slide on top of the drawer runner to provide quiet and smooth drawer operation.



Dustproofing: Wood separators installed between each drawer to prevent dust from entering through open spaces, protecting belongings stored within. These components also add to the cabinet's sturdiness.



Integrated Power Supply: Computer compatible cabinets and tv armoires have built-in surge protection power outlets and cable connector, creating easy wire management and power activation when electronic components are connected.



Nutmeg finish



Brandy finish

Au Courant



LEDA FURNITURE LTD.
350 Clayson Road, Toronto, Ontario, Canada. M9M 2H2
Tel: 416-745-9588 Fax: 416-745-1803
email: info@ledafurniture.com www.ledafurniture.com

This catalog is the property of Leda Furniture and is for the use of their authorized retailers.
Complete and/or partial reproduction without written consent from Leda Furniture management is prohibited.
Copyright MMV. Printed in Canada